

SPACE CAPACITY CHART

Meeting Room	Dimensions (LxWxH)	Area (sq.ft)	Theater	Schoolroom	Conference	U-Shape	Reception	Banquet
Music Hall	65x70x18	4550	400	225	40	50	350	240
East Parlor	26x26x18	800	50	30	20	18	50	60
West Parlor	26x26x18	800	50	30	20	18	50	60
Terrace	61x41x18	2501	200	50	30	20	250	150
Veranda	100x25x18	2500	250	40	36	20	250	190
Navigation	25x12x8	300	-	-	12	11	-	-

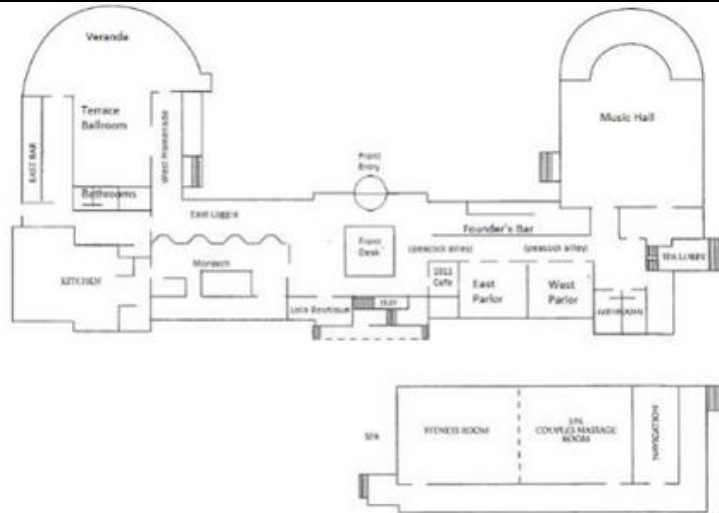

There are many indoor and outdoor locations beautifully suited for Grand Galvez weddings, reunions, corporate groups and special events. Grand Galvez is renowned for the hundreds of weddings and wedding festivities held at the property. A dedicated wedding planning team works with clients to design original, glamorous and unforgettable events. All catering is handled in-house by the hotel's talented chefs and culinary team.



GRAND GALVEZ WEDDINGS



The property's historic legacy underlines the brand positioning for this iconic hotel, which offers first-class resort amenities, spa facilities, a heated saline pool, entertainment and outstanding cuisine. The current emphasis is on the stylish and sophisticated renovations underway at Grand Galvez, focusing on an interpretation of modernism blended with the energy of the Gatsby era. The hotel's refreshing renovations and creative design touches will intuitively meet the needs of every guest.



•The Music Hall, which overlooks Centennial Green, is 5,000 square feet and features classic décor, architectural details and patio access for views of the Gulf. The Music Hall is one of two major event spaces at Grand Galvez. It has been refreshed and renovated with a beautiful sky blue, royal blue and gold accented color palette. The original historic wooden Galvez lobby bar (from the Old Galveston Club which is considered Galveston's last speakeasy) has been moved into this special event space and is a featured addition. •The Terrace & Veranda (sold together and referred to as one space) are each 2,500 square feet and separated by a line of French doors. In total, the ballroom is 5,000 square feet of space and can accommodate 300 guests for a seated dinner. The Veranda features floor-to-ceiling windows and views of the Gulf. Many years ago, the Terrace was once a very popular night club, and the Veranda was open air. •The East Parlor and West Parlor Rooms can accommodate 60 guests for a seated dinner. It is a great space with lots of natural light, perfect for luncheons and intimate receptions.

GUEST ROOMS
Guest Rooms . . . 219

GENERAL INFORMATION
• Non-Smoking Hotel

MEETING & EVENTS
• Over 13,00 Square Feet of Meeting Space
• Two Ballrooms

DINING
• Monarch
• Sunday Brunch
• Founders Bar
• Swim-Up Bar
• Room Service

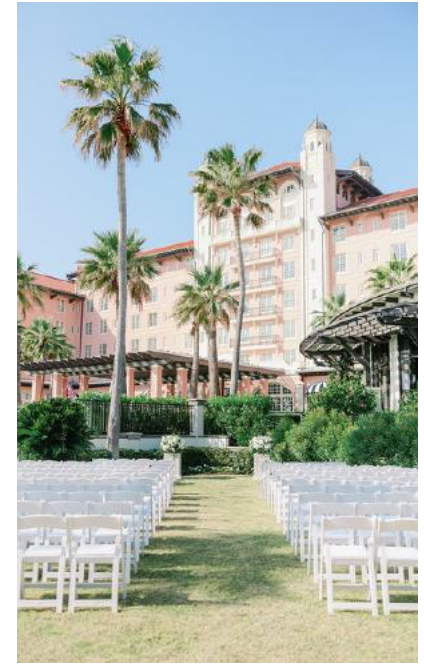

• Oleander Garden is an outdoor space that features trickling water, greenery and an intimate setting. It is more than 2,700 square feet of space and can accommodate 250 guests. Page 7 of 7 •Centennial Green is a dramatic outdoor space with a charming pergola and expansive views of the Gulf. It is more than 9,000 square feet of space and can accommodate 300 guests. •The Center Lawn is framed by gorgeous palm trees with a stunning view of the hotel. It is an outdoor space that can accommodate 100 guests.

SERVICES & ACTIVITIES

- Lolo Boutique
- Full-Service Spa
- Salon
- Fitness Center
- Valet Parking
- Wireless Internet - Guest Rooms and Public Spaces
- Outdoor Pool
- Cabanas



TRANSPORTATION

- 45 Minutes to Houston Hobby Airport
- 75 Minutes to Houston Bush Intercontinental Airport
- 1.5 Mile Radius to Galveston Cruise Terminal